

# HC-ADV-B24-1TM32-1SM25-EMC-PS - Housing



1423228

<https://www.phoenixcontact.com/us/products/1423228>

Please be informed that the data shown in this PDF document is generated from our online catalog. Please find the complete data in the user documentation. Our general terms of use for downloads are valid.



Sleeve housing B24, Screw locking mechanism, material: Die-cast aluminum, salt water resistant, cable outlets: 2, straight, lateral, 1x M32 / 1x M25, height: 93.7 mm, cable gland: none, Offshore/EMC

## Commercial data

|                                      |                                |
|--------------------------------------|--------------------------------|
| Item number                          | 1423228                        |
| Packing unit                         | 1 pc                           |
| Minimum order quantity               | 50 pc                          |
| Note                                 | Made to order (non-returnable) |
| Sales key                            | BF58                           |
| Product key                          | BF7APH                         |
| GTIN                                 | 4055626327907                  |
| Weight per piece (including packing) | 375 g                          |
| Weight per piece (excluding packing) | 375 g                          |
| Customs tariff number                | 85389099                       |
| Country of origin                    | PL                             |

# HC-ADV-B24-1TM32-1SM25-EMC-PS - Housing



1423228

<https://www.phoenixcontact.com/us/products/1423228>

## Technical data

### Notes

|         |  |
|---------|--|
| General | for contact inserts HC-B24, BB46, D64, DD108, HV10/16, M |
|---------|--|

### Product properties

|                              |                            |
|------------------------------|----------------------------|
| Type                         | B24                        |
| Product type                 | Housing with screw locking |
| Application                  | Offshore/EMC               |
| No. of cable outlets         | 2                          |
| Type of the screw connection | 1x M32 / 1x M25            |
| Fixing screws                | M6 (screw head: Pozidrive) |
| Housing type                 | Sleeve housing             |
| Shielded                     | yes                        |
| Cable outlet                 | straight, lateral          |
| Pg screw connection          | none                       |

### Connection data

|                   |  |
|-------------------|--|
| Tightening torque | 3 Nm ... 5 Nm (for M6 mounting screws on the sleeve housing) |
|-------------------|--|

### Dimensions

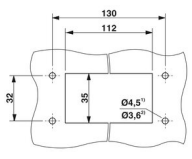
|                     |  |
|---------------------|--|
| Dimensional drawing |  |
| Width               | 57 mm  |
| Height              | 93.7 mm  |
| Length              | 152 mm   |

### Installation dimensions

|                               |        |
|-------------------------------|--------|
| Width of the assembly cutout  | 35 mm  |
| Length of the assembly cutout | 112 mm |

### Material specifications

|                          |   |
|--------------------------|---|
| Seal material            | NBR, conductive                         |
| Housing surface material | uncoated                                |
| Locking latch material   | Stainless steel                         |
| Impact strength          | IK09                                    |
| Housing material         | Die-cast aluminum, salt water resistant |

### Environmental and real-life conditions

#### Ambient conditions

|                      |      |
|----------------------|------|
| Degree of protection | IP66 |
|----------------------|------|

# HC-ADV-B24-1TM32-1SM25-EMC-PS - Housing



1423228

<https://www.phoenixcontact.com/us/products/1423228>

|                                 |                     |
|---------------------------------|---------------------|
|                                 | IP68 (0.2 bar/24 h) |
| Enclosure rating (NEMA)         | 4 (NEMA 250)        |
|                                 | 4X (NEMA 250)       |
|                                 | 6P (NEMA 250)       |
|                                 | 12 (NEMA 250)       |
| Impact strength                 | IK09                |
| Ambient temperature (operation) | -40 °C ... 125 °C   |

## Mechanical properties

### Mechanical data

|                              |                 |
|------------------------------|-----------------|
| Type of the screw connection | 1x M32 / 1x M25 |
|------------------------------|-----------------|

## Mounting

|                       |  |
|-----------------------|--|
| Assembly instructions | M6 locking screw, with Pozidrive head  |
|                       | To ensure optimum shielding, any insulating power coating must be removed from the profile gasket area on the control cabinet panel. Tightening torque of locking screw: 3 Nm. |
| Fixing screws         | M6 (screw head: Pozidrive)   |

1423228

<https://www.phoenixcontact.com/us/products/1423228>

## Drawings

Dimensional drawing

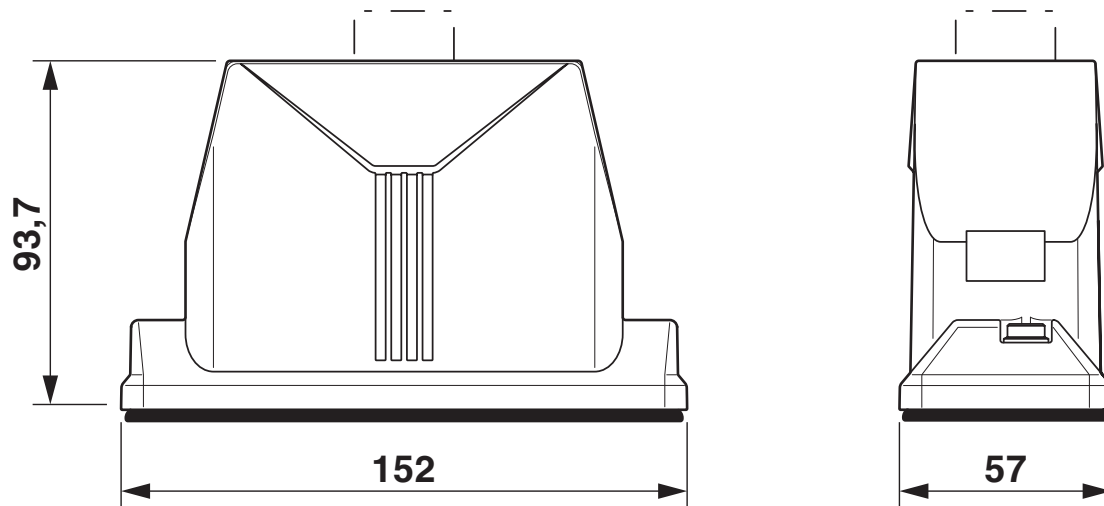

Dimensional drawing

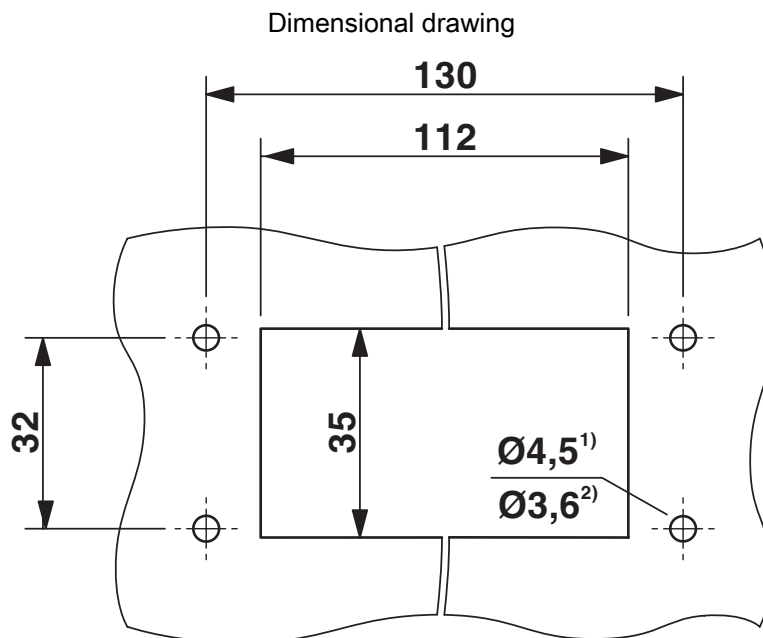

### Mounting cutout

1) when M4 screws are used

2) when self-tapping Torx® screws are used (Torx® 20, M4)

1423228

<https://www.phoenixcontact.com/us/products/1423228>

## Classifications

### ECLASS

|             |          |
|-------------|----------|
| ECLASS-11.0 | 27440202 |
| ECLASS-13.0 | 27440202 |

### ETIM

|          |          |
|----------|----------|
| ETIM 8.0 | EC000437 |
|----------|----------|

### UNSPSC

|             |          |
|-------------|----------|
| UNSPSC 21.0 | 31261500 |
|-------------|----------|

# HC-ADV-B24-1TM32-1SM25-EMC-PS - Housing



1423228

<https://www.phoenixcontact.com/us/products/1423228>

## Environmental product compliance

|            |   |
|------------|---|
| China RoHS | Environmentally friendly use period: unlimited = EFUP-e |
|            | No hazardous substances above threshold values          |

# HC-ADV-B24-1TM32-1SM25-EMC-PS - Housing



1423228

<https://www.phoenixcontact.com/us/products/1423228>

## Accessories

### HC-B-AF - Panel-mount flange

1686533

<https://www.phoenixcontact.com/us/products/1686533>



Panel-mount flange for HEAVYCON ADVANCE housing

---

### HC-B-AF-SET - Panel-mount flange

1604638

<https://www.phoenixcontact.com/us/products/1604638>

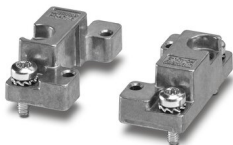

Panel-mount flange for HEAVYCON ADVANCE housing, set consisting of: 2 panel-mount flanges with 4 self-tapping screws (M4, Torx<sup>®</sup>) and 4 fan-type washers

# HC-ADV-B24-1TM32-1SM25-EMC-PS - Housing



1423228

<https://www.phoenixcontact.com/us/products/1423228>

## HC-B 24-TMS-SD-IP50 - Protective cover

1690765

<https://www.phoenixcontact.com/us/products/1690765>



Protective cover B24, with clip locking, protective cover material: PA, height: 31.2 mm, seal: no, with lanyard

---

## HC-B 24-TMS-SD-IP66 - Protective cover

1411520

<https://www.phoenixcontact.com/us/products/1411520>



HEAVYCON ADVANCE, IP66, B24 protective cover for panel mounting side, with screw locking, with retaining cord, diameter of retaining cord eyelet: 3 mm



# HC-ADV-B24-1TM32-1SM25-EMC-PS - Housing

1423228

<https://www.phoenixcontact.com/us/products/1423228>

## G-INS-M25-M68N-NNES-S - Cable gland

1411165

<https://www.phoenixcontact.com/us/products/1411165>



Cable gland, material for screw connection: Brass, nickel-plated, external cable diameter 11 mm ... 17 mm, shielding: no, connecting thread: M25 x 1.5, color: silver, with O-ring

---

## G-INSEC-M25-S68N-NCRS-S - Cable gland

1411190

<https://www.phoenixcontact.com/us/products/1411190>



Cable gland, material for screw connection: Brass, nickel-plated, external cable diameter 11 mm ... 16 mm, shielding: yes, connecting thread: M25 x 1.5, color: silver, with O-ring

# HC-ADV-B24-1TM32-1SM25-EMC-PS - Housing

1423228

<https://www.phoenixcontact.com/us/products/1423228>

## G-INS-M32-M68N-NNES-S - Cable gland

1411166

<https://www.phoenixcontact.com/us/products/1411166>



Cable gland, material for screw connection: Brass, nickel-plated, external cable diameter 15 mm ... 21 mm, shielding: no, connecting thread: M32 x 1.5, color: silver, with O-ring

---

## G-INSEC-M32-M68N-NCRS-S - Cable gland

1411191

<https://www.phoenixcontact.com/us/products/1411191>



Cable gland, material for screw connection: Brass, nickel-plated, external cable diameter 14 mm ... 21 mm, shielding: yes, connecting thread: M32 x 1.5, color: silver, with O-ring

# HC-ADV-B24-1TM32-1SM25-EMC-PS - Housing



1423228

<https://www.phoenixcontact.com/us/products/1423228>

## US-EMLP (20X9) CUS - Plastic label

0830085

<https://www.phoenixcontact.com/us/products/0830085>

Plastic label, can be ordered: by card, white, labeled according to customer specifications, mounting type: adhesive, lettering field size: 20 x 9 mm, Number of individual labels: 75



---

## HC-B-TMS-ERSSCHR - Screw

1584198

<https://www.phoenixcontact.com/us/products/1584198>

Replacement locking screw, M6, stainless steel, for HEAVYCON ADVANCE housing type HC-B...TMS...STA, head: Pozidrive



# HC-ADV-B24-1TM32-1SM25-EMC-PS - Housing



1423228

<https://www.phoenixcontact.com/us/products/1423228>

## SF-BIT-HEXB 5-89 - Screw insert

1208911

<https://www.phoenixcontact.com/us/products/1208911>



Screw bit, hexagonal with ball head, E6.3-1/4" drive, size: Hex 5 x 89 mm, hardened, suitable for holder according to DIN 3126-F 6.3/ISO 1173

---

## SF-M BH - Screwdriver

1212070

<https://www.phoenixcontact.com/us/products/1212070>



Bit screwdriver, with 1/4" quick-action chuck, handle length 119 mm, 2-component handle, with non-slip grip, suitable for bits according to DIN 3126-C 6.3 and E 6.3/ISO 1173, magnetic

---

Phoenix Contact 2023 © - all rights reserved  
<https://www.phoenixcontact.com>

Phoenix Contact USA  
586 Fulling Mill Road  
Middletown, PA 17057, United States  
(+717) 944-1300  
[info@phoenixcon.com](mailto:info@phoenixcon.com)